

**£150,000**

Bourne May Road, Knott  
End On Sea, Poulton Le  
Fylde FY6

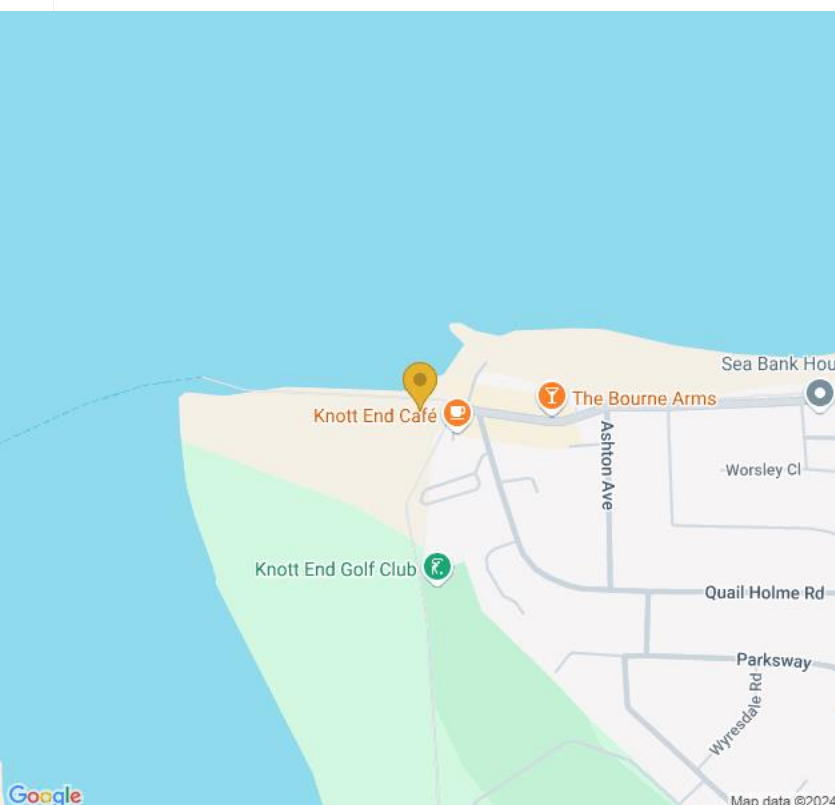
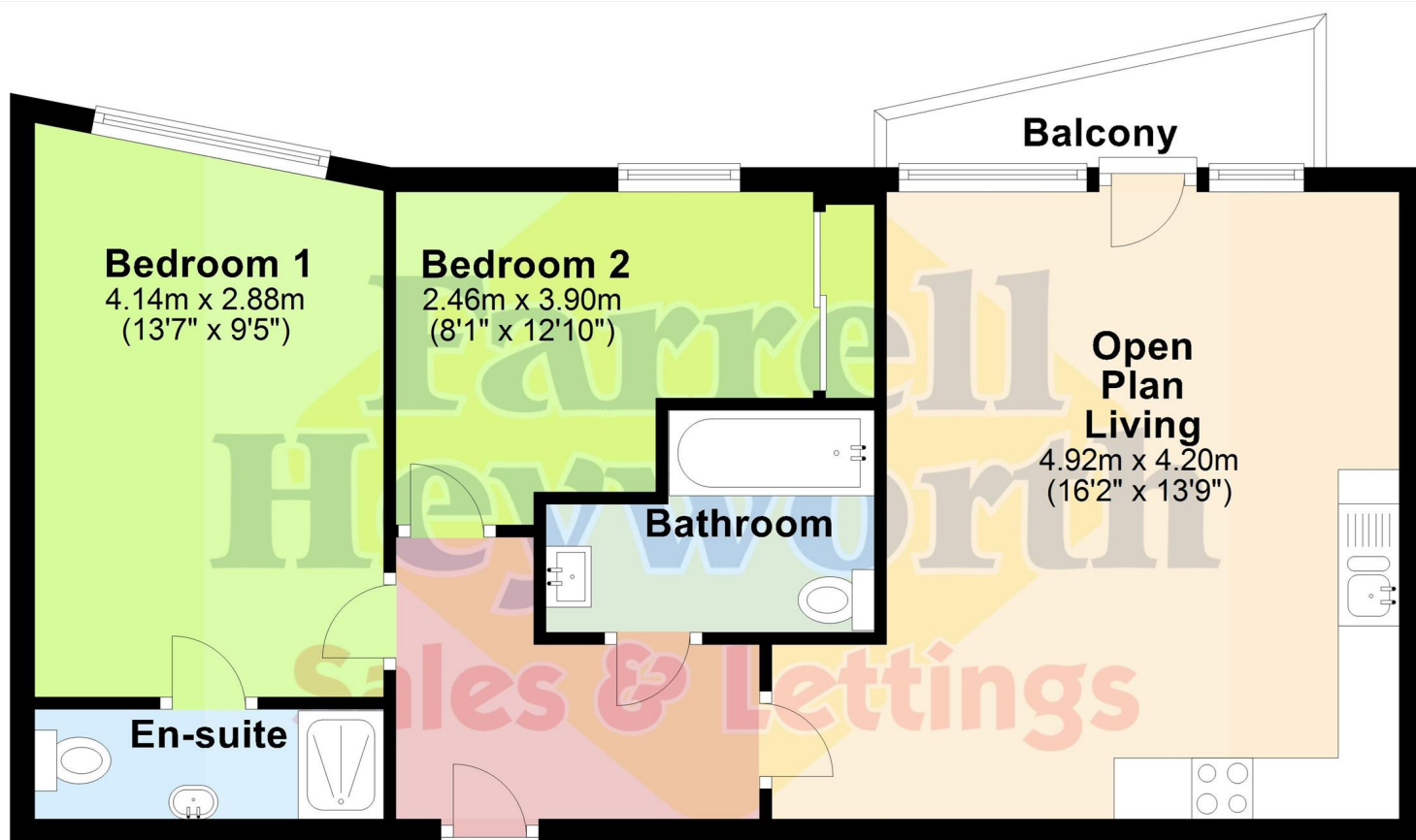

**Poulton  
Landmark House  
5a Cleveleys Avenue FY5 2UH**

**Tel: 01253 886000**

**Email: [poulton@farrellheyworth.co.uk](mailto:poulton@farrellheyworth.co.uk)**

**<https://www.farrellheyworth.co.uk/poulton>**



- **\*\*VIRTUAL VIEWING AVAILABLE CLICK ON THE VIDEO TOUR ABOVE\*\***
- **Two Bedroom Third Floor Apartment With Sea Views And Balcony**
- **Open Plan Lounge, Dining Room & Kitchen, Modern Bathroom**
- **Two Bedrooms, En Suite Shower To Master, Allocated Parking**
- **Great Location, Close to Local Amenities, & Coastal Walks**





A fantastic opportunity to purchase this well presented third floor, two bedroom luxury apartment overlooking the waterfront at Knott End.

On internal inspection the property briefly comprises entrance hallway, inner hallway, open plan lounge/kitchen/dining area, a bathroom and two bedrooms with en suite to the master.

Externally the property has allocated parking and a balcony with sea views.

Viewings are highly recommended to appreciate this superb property on offer.

Tenure: Leasehold  
 Leasehold information: Terms: 999 Years from 1st January 2015  
 Current Ground Rent: £250 per annum  
 Current Maintenance/Service Charges: £1452 per annum  
 Council Tax: Band B









