

Ground Floor

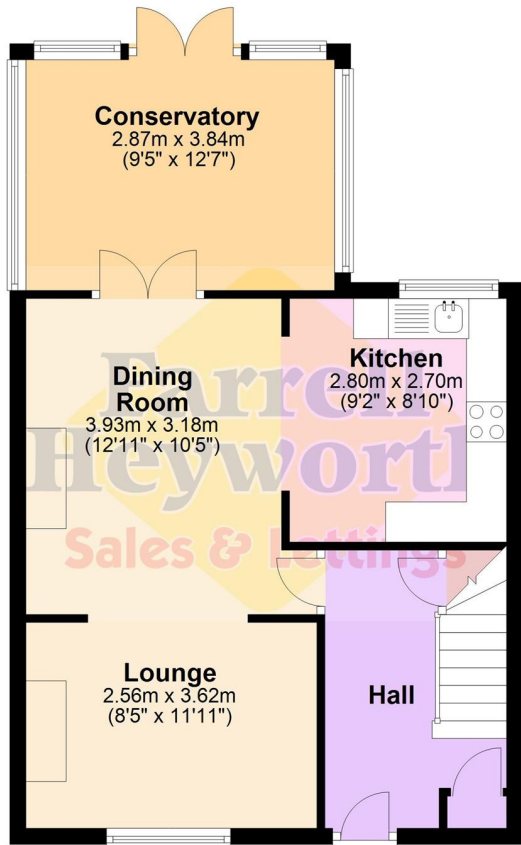

First Floor

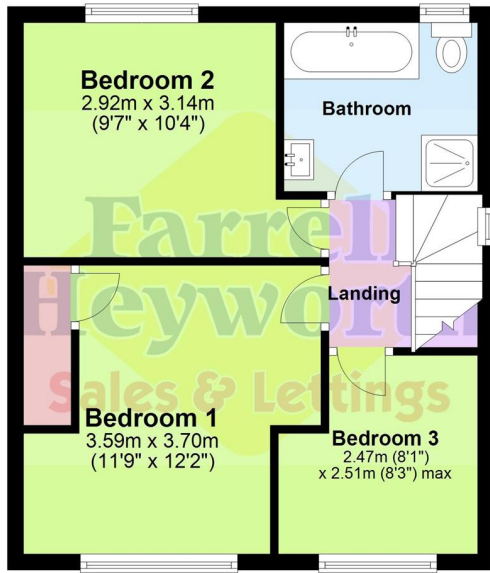

£190,000

Langdale Road, Lancaster
LA1

**Farrell
Heyworth**
Sales & Lettings

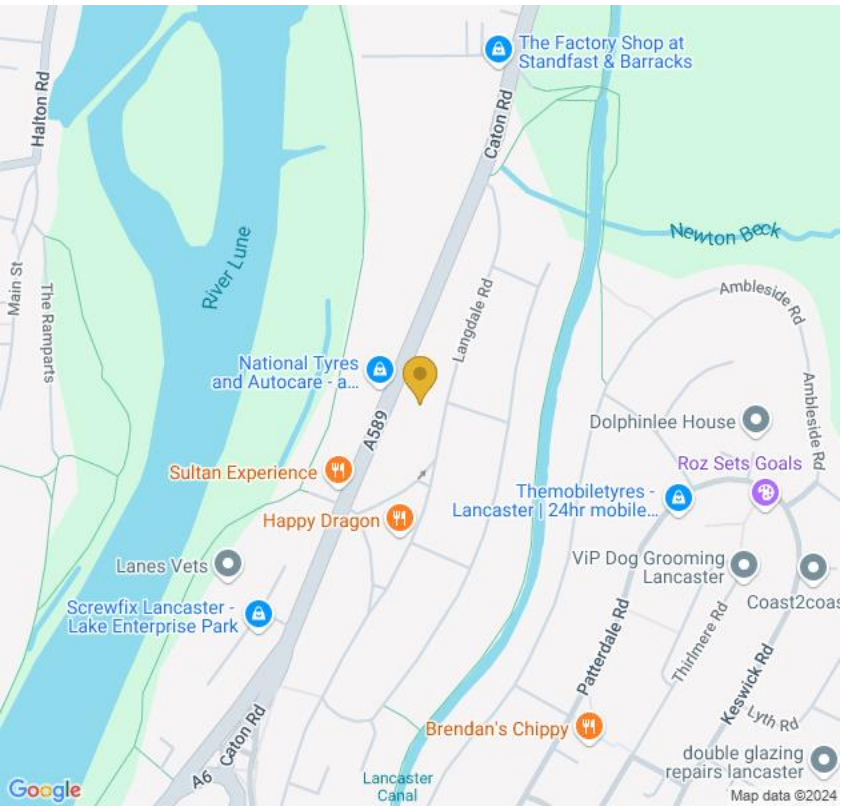

**Farrell
Heyworth**
Sales & Lettings

Lancaster
18 New Street
Lancaster LA1 1EG

Tel: 01524 842222
Email: lancaster@farrellheyworth.co.uk
<https://www.farrellheyworth.co.uk/lancaster>



- ****VIRTUAL VIEWING AVAILABLE. CLICK ON THE VIDEO TOUR ABOVE****
- **Three Bedroom Semi-Detached Family Home With Driveway**
- **Open Plan Lounge, Dining Room & Kitchen, Family Bathroom**
- **Two Double Bedrooms, One Single, Great Size Rear Garden**
- **Great Location, Close To Local Shops, Schools & Transport Links**

Every care has been taken with the preparation of these Particulars but complete accuracy cannot be guaranteed. If there is any point, which is of particular importance to you, we will be pleased to check the information for you. These Particulars do not constitute a contract or part of a contract.

All measurements quoted are approximate and plans are for general guidance and are not to scale. The Fixtures, Fittings & Appliances have not been tested and therefore no guarantee can be given that they are in working order. Photographs are reproduced for general information and it cannot be inferred that any item shown is included in the sale.

Company Details - Farrell Heyworth Limited.

Registered Office: Second Floor Office Suite, The Pavillion, Church Street, Lancaster, LA1 1EX

Registered in England No. 3798432

Directors CP Heyworth FNAEA, JF Collins, JR Collins, SW Penny FRICS, JAG Shellcross MNAEA, JA French

EPC E

www.farrellheyworth.co.uk



Tenure: Freehold
Council Tax: Band A



**We can search
1,000s of
mortgages
for you**

1 adviser - 80 lenders - 10,000 mortgage schemes!



**Mortgage
Advice Bureau**

Call: 0800 389 1666

Online: www.mortgageadvicebureau.com/farrelltheyworth

**Your home may be repossessed if you do not keep up repayments on your mortgage.
There will be a fee for mortgage advice. The actual amount you pay will depend upon your
circumstances.**

MAB 6451

