

£329,950

Brier Drive, Heysham,
Morecambe LA3

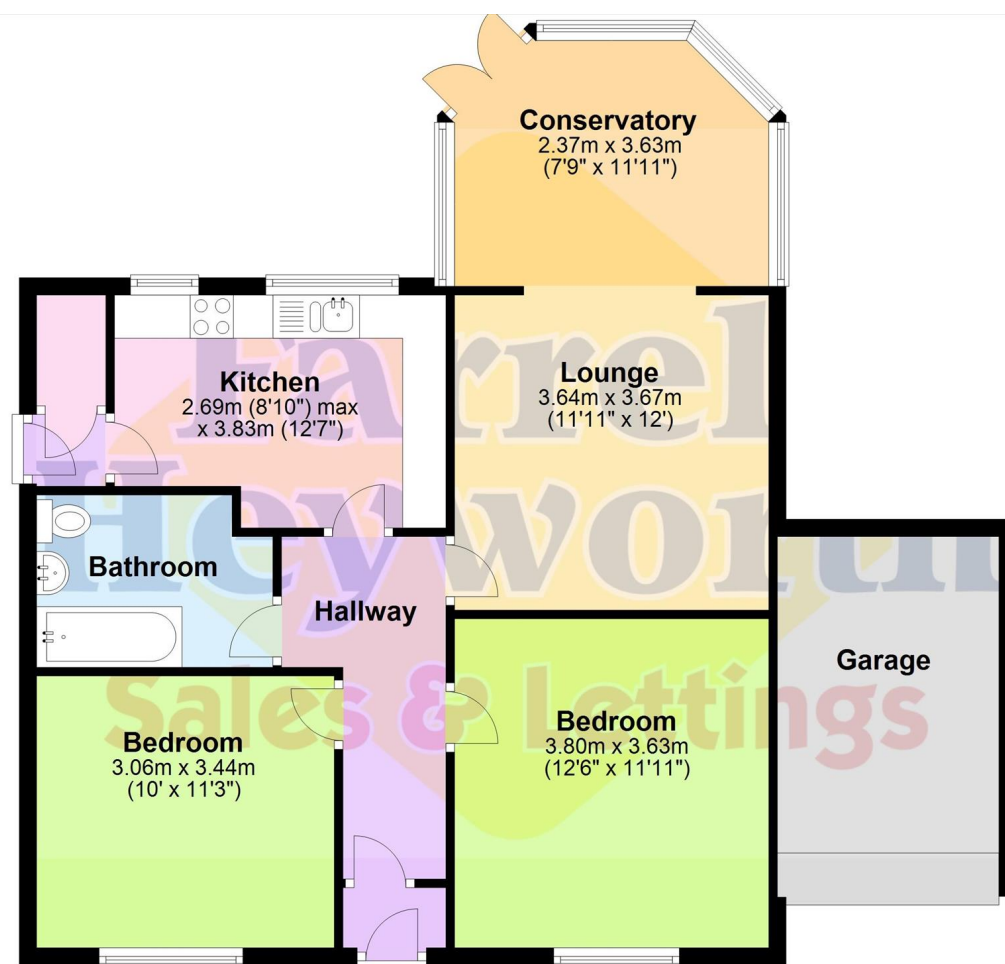

- ****VIRTUAL VIEWING AVAILABLE. CLICK ON THE VIDEO TOUR ABOVE****
- **Two Bedroom Link Detached Bungalow With Drive**
- **Lounge, Kitchen, Conservatory Plus Rear Garden**
- **Two Good Size Bedrooms, Bathroom, Garage**
- **Sought After Location, Close To Amenities & Transport Links**

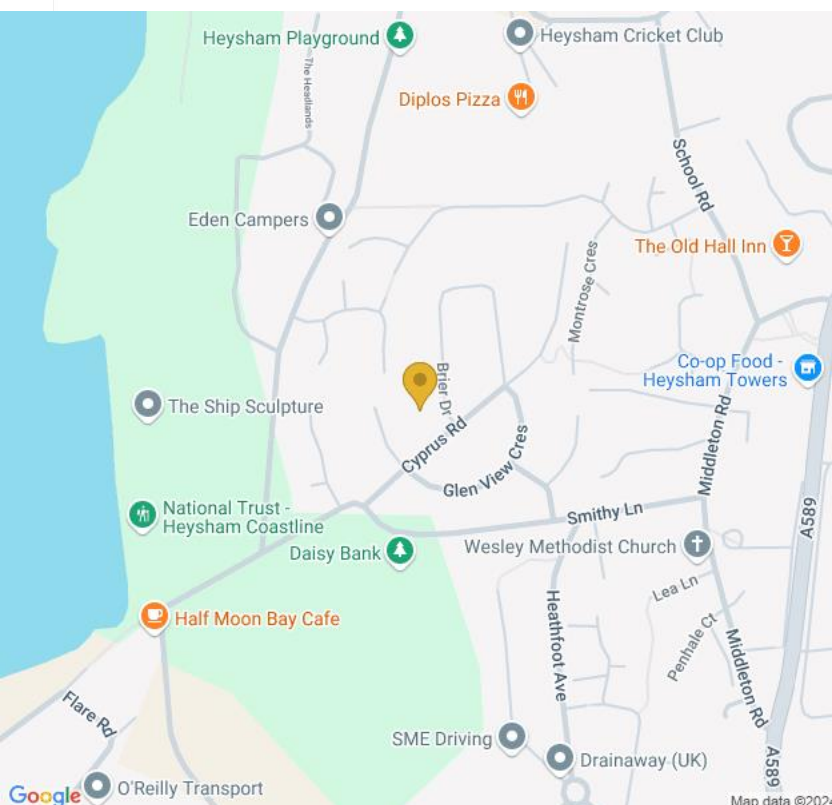



This well presented two bedroom link detached true bungalow is situated in a popular residential location of Heysham, close to local amenities and transport links.

The accommodation comprises entrance hallway, good size well-presented reception room open plan to the conservatory and a kitchen with fitted wall and base units. There are two bedrooms and a fitted bathroom.

Externally are good sized gardens, driveway and garage.

The property is located on Brier Drive and Cyprus Road, the estate was constructed by reputable local builder Holroyd. The estate is located very close to Heysham Village centre and is minutes from Half Moon Bay and the stunning Heysham Coastline.

Tenure: Freehold
Council Tax: Band C



We can search 1,000s of mortgages for you

1 adviser - 80 lenders - 10,000 mortgage schemes!

Mortgage Advice Bureau

Call: 0800 389 1666
Online: www.mortgageadvicebureau.com/farrellheyworth

Your home may be repossessed if you do not keep up repayments on your mortgage. There will be a fee for mortgage advice. The actual amount you pay will depend upon your circumstances.

MAB 6451

COVENTRY

HALIFAX

FURNESSE

Woolwich

Kensington

platform

SKIPTON

Ca

We are here

BM SOLUTIONS

ACCORD MORTGAGES

the mortgage experts

QUALITY

the mortgage experts

A view of the exterior of the bungalow, showing a paved patio with a table and chairs, a conservatory, and a driveway. The property is surrounded by greenery and other houses in the background.

Buying or selling a home?

No sale no fee conveyancing
Dedicated conveyancer
Speedy completions



