

£200,000

Meadow Avenue, Preesall,
Poulton Le Fylde FY6

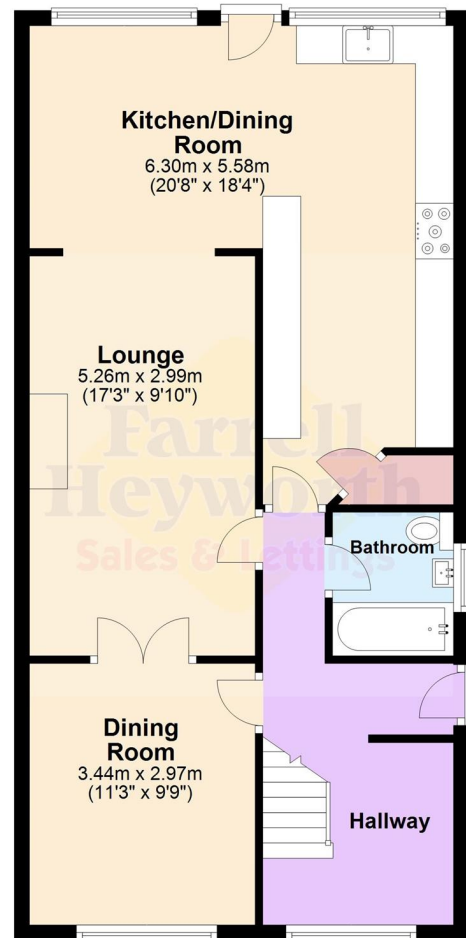

Ground Floor

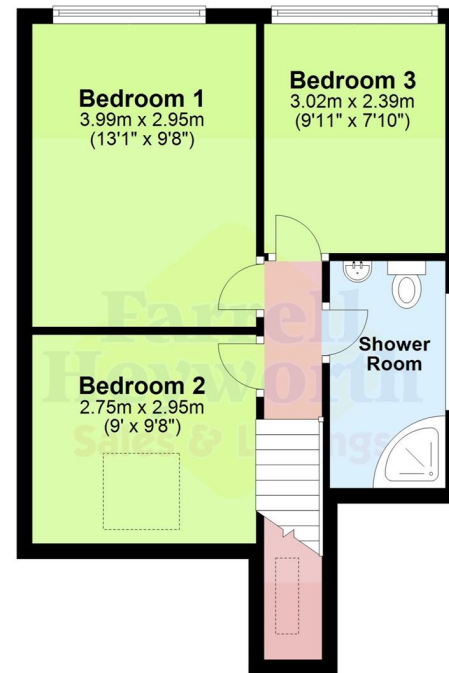

First Floor



- ****VIRTUAL VIEWING AVAILABLE. CLICK ON THE VIDEO TOUR ABOVE****
- **Three/Four Bedroom Semi-Detached Family Home With Driveway**
- **Open Plan Kitchen/Dining, Two Bathrooms, Rear Garden**
- **Spacious Lounge, Separate Dining Room/ Bedroom Four**
- **Great Location, Close to Local Amenities**

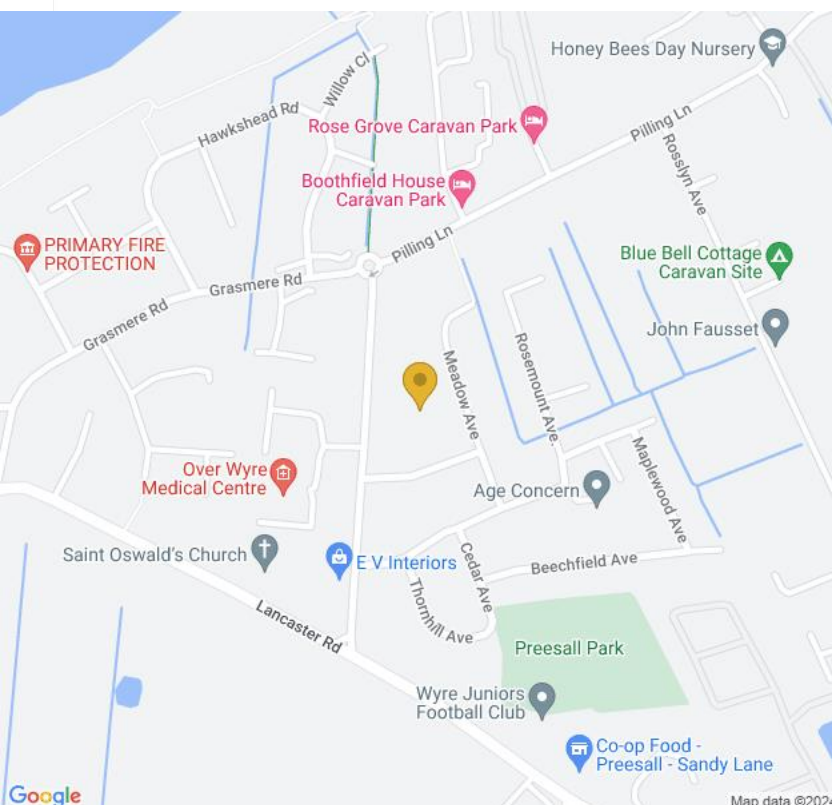

**Poulton
Landmark House
5a Cleveleys Avenue FY5 2UH**

**Tel: 01253 886000
Email: poulton@farrellheyworth.co.uk
<https://www.farrellheyworth.co.uk/poulton>**

Company Details - Farrell Heyworth Limited.

Registered Office: Second Floor Office Suite, The Pavillion, Church Street, Lancaster, LA1 1EX

Registered in England No. 3798432

Directors CP Heyworth FNAEA, JF Collins, JR Collins, SW Penny FRICS, JAG Shellcross MNAEA, JA French

Every care has been taken with the preparation of these Particulars but complete accuracy cannot be guaranteed. If there is any point, which is of particular importance to you, we will be pleased to check the information for you. These Particulars do not constitute a contract or part of a contract.

All measurements quoted are approximate and plans are for general guidance and are not to scale. The Fixtures, Fittings & Appliances have not been tested and therefore no guarantee can be given that they are in working order. Photographs are reproduced for general information and it cannot be inferred that any item shown is included in the sale.

EPC D

www.farrellheyworth.co.uk



We are pleased to present to the market this well presented three/four bedroom semi detached family home, located in a popular area of Preesall.

Internally the accommodation comprises a spacious lounge, a bright, open plan dining kitchen and a separate dining room which can be used as a fourth bedroom.

Stairs lead to the first floor with three bedrooms and a shower room.

Externally is a driveway with access to the rear garden which is well maintained and a good size.

Tenure: Freehold
Council Tax: Band B



