

£240,000

Wood View, Burton In
Lonsdale, Carnforth LA6

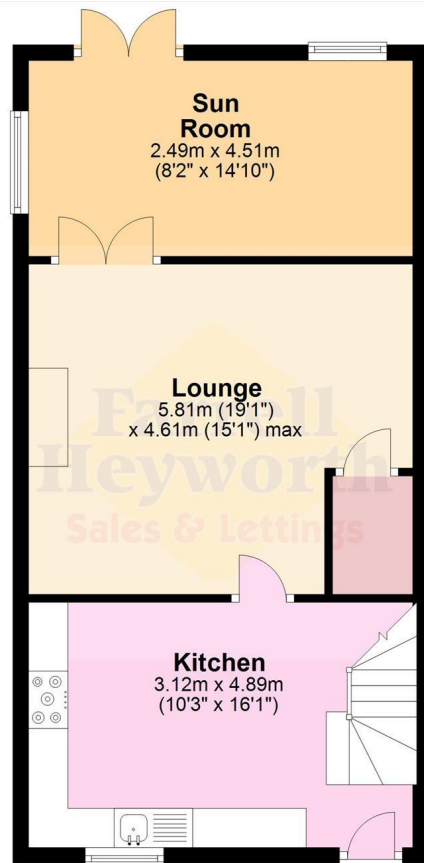

Ground Floor

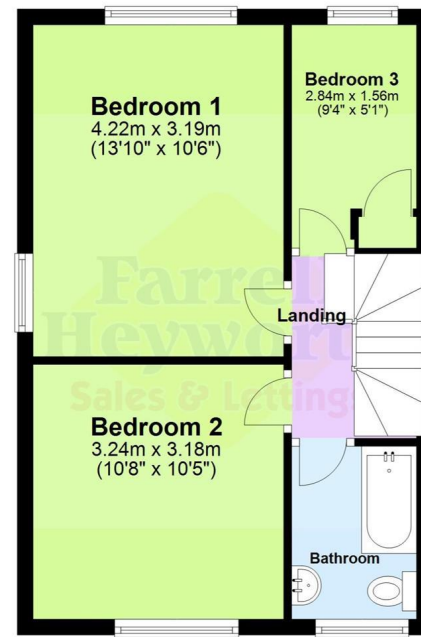

First Floor

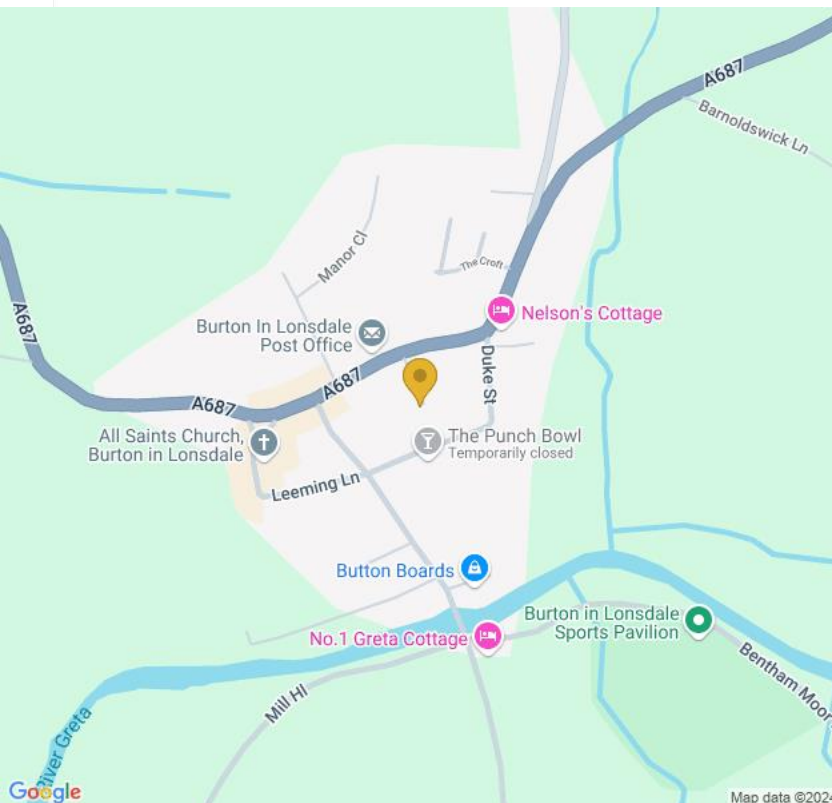

- ****VIRTUAL VIEWING AVAILABLE. CLICK ON THE VIDEO TOUR ABOVE****
- **Three Bedroom End Terraced Home On A Private Road**
- **Spacious Lounge, Modern Fitted Kitchen, Family Bathroom, Sun Room**
- **Generous Garden With Fire Pit And Multiple Parking Spaces**
- **A Private House With Great Views. Call To Avoid Missing Out**



We are pleased to offer this three bedroom end terrace home on a private road in Burton in Lonsdale which is within walking distance to local amenities, public transport links.

Internally you will find a modern fitted dining kitchen with staircase to the first floor, good size lounge with feature stone fireplace and double doors leading to the sun room which also has double doors leading to the garden.

To the first floor are three bedrooms (two doubles and a single) and a bathroom suite.

To the front of the property is ample parking space and a timber lodge, currently being used as a home gym. To the rear is a good size garden with great views.

A lovely property in a private, secluded position with no passing traffic, highly recommended to view!

Tenure: Freehold
Council Tax: Band C





