

Ground Floor

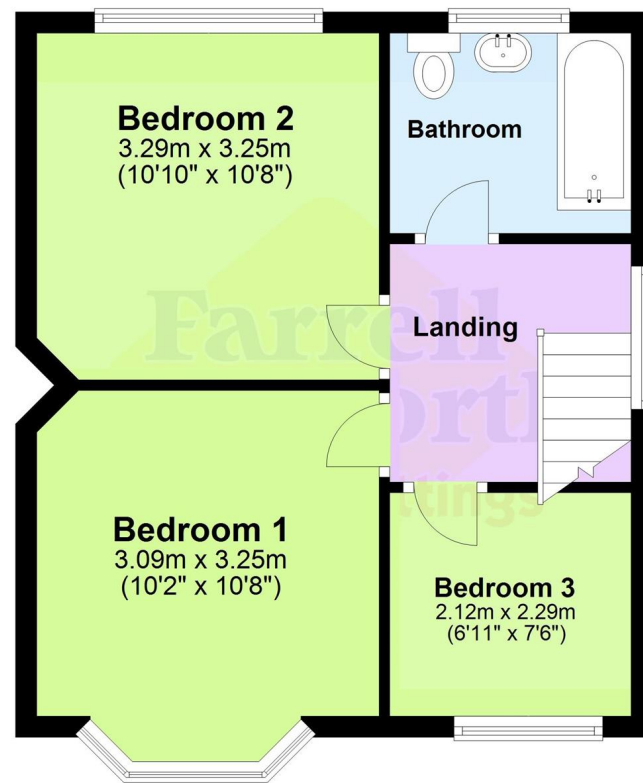

First Floor

O.O
£140,000

Kenilworth Avenue,
Fleetwood FY7

**Farrell
Heyworth**
Sales & Lettings



- ****VIRTUAL VIEWING AVAILABLE. CLICK ON THE VIDEO TOUR ABOVE****
- **Three Bedroom Semi Detached Family Home**
- **Spacious Lounge, Stylish Kitchen/Diner, Good Size Rear Garden**
- **Located Close To Shops & Amenities**
- **Please Call To Avoid Missing Out**

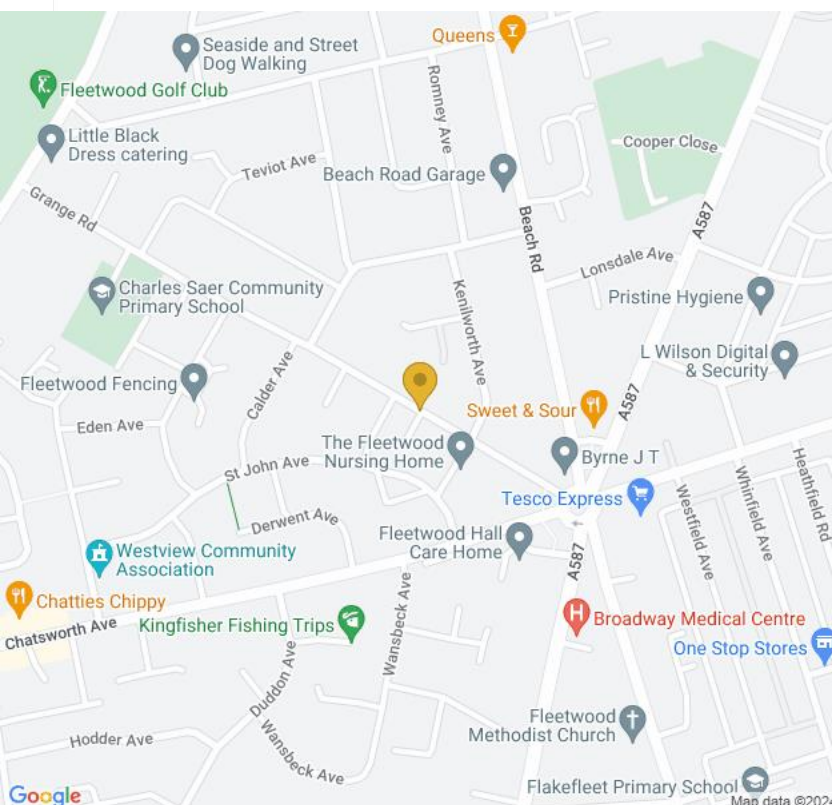

**Farrell
Heyworth**
Sales & Lettings

**Cleveleys
Landmark House
5a Cleveleys Avenue FY5 2UH**

**Tel: 01253 858200
Email: cleveleys@farrellheyworth.co.uk
<https://www.farrellheyworth.co.uk/cleveleys>**

Company Details - Farrell Heyworth Limited.

Registered Office: Second Floor Office Suite, The Pavillion, Church Street, Lancaster, LA1 1EX

Registered in England No. 3798432

Directors CP Heyworth FNAEA, JF Collins, JR Collins, SW Penny FRICS, JAG Shellcross MNAEA, JA French

Every care has been taken with the preparation of these Particulars but complete accuracy cannot be guaranteed. If there is any point, which is of particular importance to you, we will be pleased to check the information for you. These Particulars do not constitute a contract or part of a contract.

All measurements quoted are approximate and plans are for general guidance and are not to scale. The Fixtures, Fittings & Appliances have not been tested and therefore no guarantee can be given that they are in working order. Photographs are reproduced for general information and it cannot be inferred that any item shown is included in the sale.

EPC E

www.farrellheyworth.co.uk



We are pleased to present to the market this beautifully presented three bedroom semi detached home, located in a popular area of Fleetwood,.

Internally the accommodation comprises, a spacious lounge and a modern, stylish dining kitchen with patio doors to the garden.

Stairs lead to the first floor, with three bedrooms and a family bathroom.

Externally is a driveway with access to the rear garden which is a good size.

Tenure: Freehold
Council Tax: Band B





