

Ground Floor

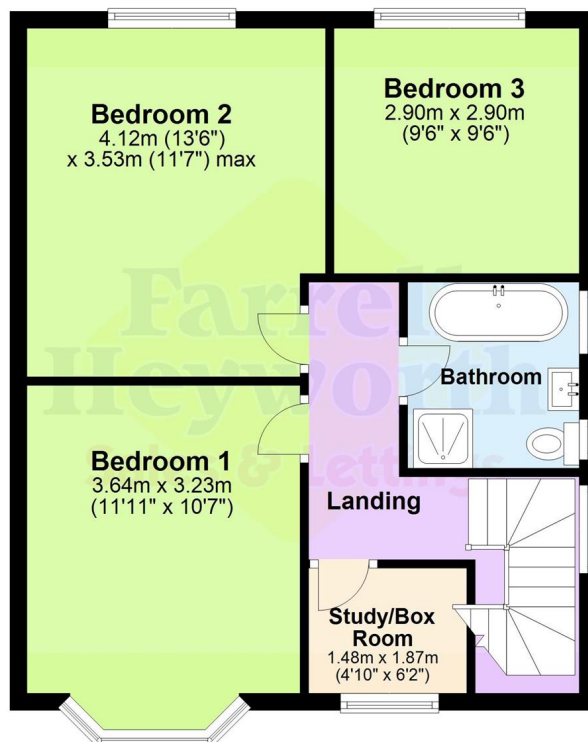

First Floor

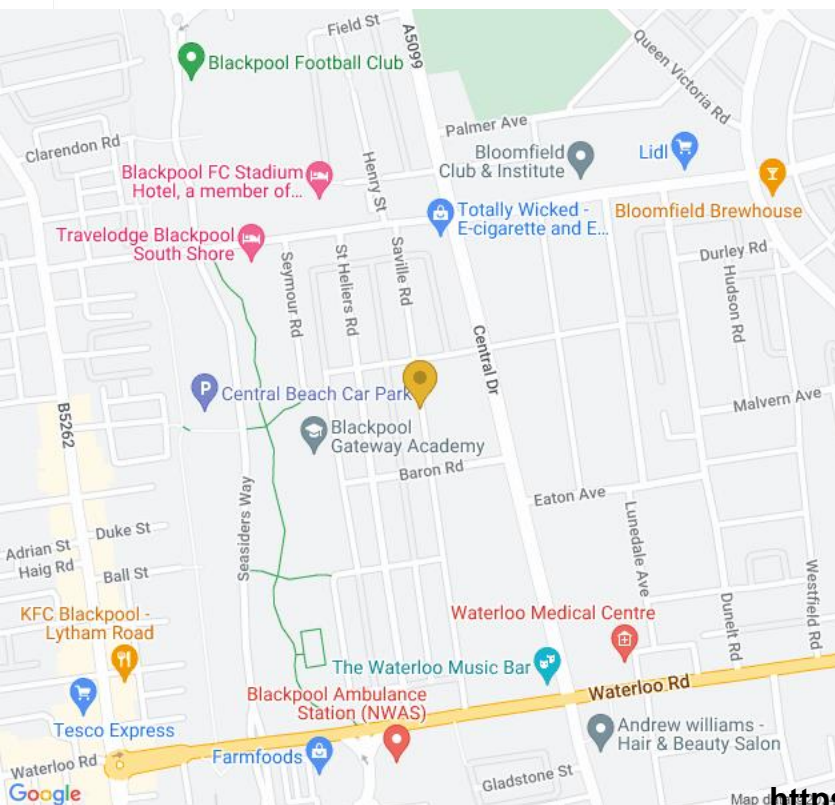

**Blackpool South
Landmark House
5a Cleveleys Avenue FY5 2UH**

Tel: 01253 341000

Email: southshore@farrellheyworth.co.uk

https://www.farrellheyworth.co.uk/blackpool_south

Every care has been taken with the preparation of these Particulars but complete accuracy cannot be guaranteed. If there is any point, which is of particular importance to you, we will be pleased to check the information for you. These Particulars do not constitute a contract or part of a contract.

All measurements quoted are approximate and plans are for general guidance and are not to scale. The Fixtures, Fittings & Appliances have not been tested and therefore no guarantee can be given that they are in working order. Photographs are reproduced for general information and it cannot be inferred that any item shown is included in the sale.

Company Details - Farrell Heyworth Limited.

Registered Office: Second Floor Office Suite, The Pavillion, Church Street, Lancaster, LA1 1EX

Registered in England No. 3798432

Directors CP Heyworth FNAEA, JF Collins, JR Collins, SW Penny FRICS, JAG Shellcross MNAEA, JA French

£150,000

**Saville Road, Blackpool
FY1**

**Farrell
Heyworth**
Sales & Lettings



- ****VIRTUAL VIEWING AVAILABLE. CLICK ON THE VIDEO TOUR ABOVE****
- **Three Bedroom Semi-Detached Family Home**
- **Two Reception Rooms, Fitted Kitchen. Box Room/Office/Nursery**
- **Downstairs WC. Driveway & Garage. Spacious Rear Garden**
- **Great Location. Viewing Recommended**

EPC C

www.farrellheyworth.co.uk



We are pleased to present to the market this spacious semi detached property, located in a popular area of Blackpool.

Internally the accommodation comprises a lounge, a spacious rear reception room, kitchen and dining room, and a downstairs WC.

Stairs lead to the first floor, with three well-proportioned bedrooms, plus a dressing room/study or nursery and a spacious four piece family bathroom.

Externally is a driveway leading to a garage, with access to the rear garden which is a good size.

Tenure: Freehold
Council Tax: Band C





