

Westminster Road,
Morecambe LA4

£170,000

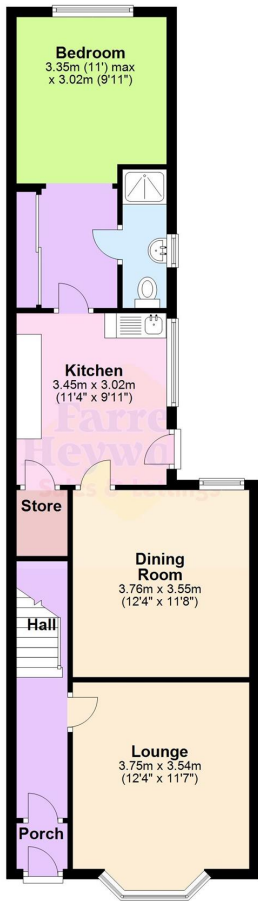

Ground Floor

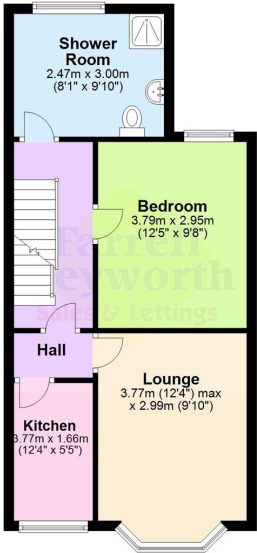

First Floor

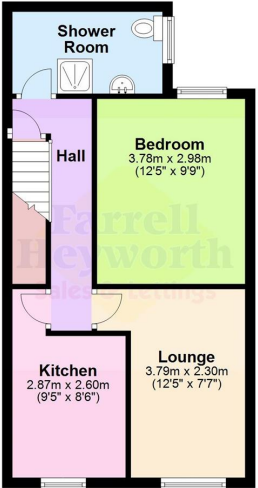

Second Floor

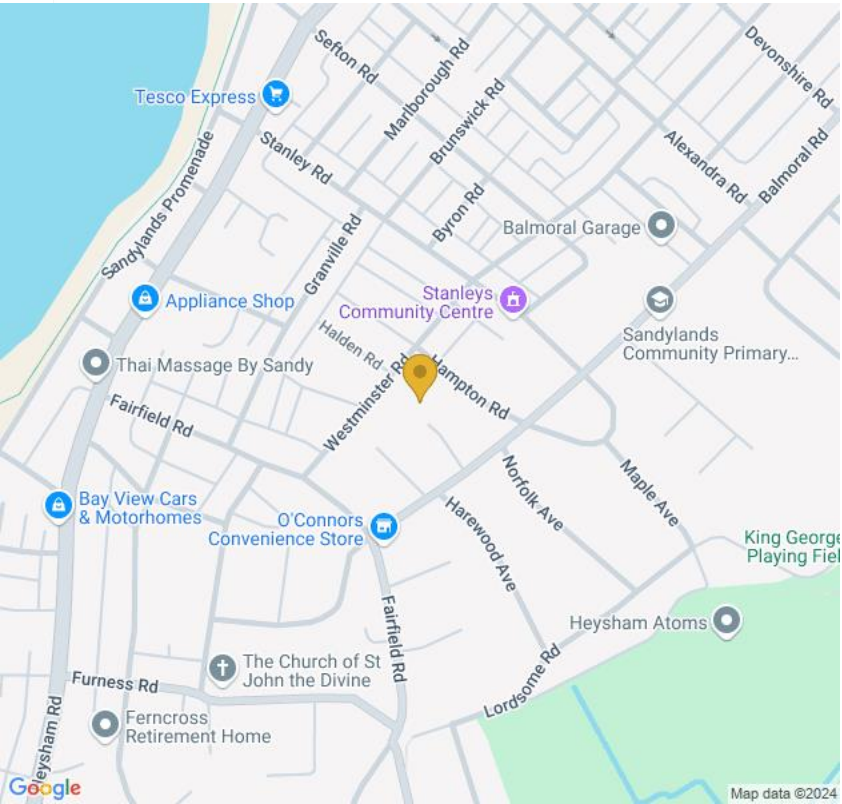

Farrell
Heyworth
Sales & Lettings

Morecambe
3-7 Victoria Street
Morecambe LA4 4AE

Tel: 01524 832929

Email: morecambe@farrellheyworth.co.uk

<https://www.farrellheyworth.co.uk/morecambe>



- ****VIRTUAL VIEWING AVAILABLE. CLICK ON THE VIDEO TOUR ABOVE****
- **Mid Terrace Property In Morecambe's West End**
- **Currently Split Into Three One Bedroom Flats**
- **Central Location Close to Shopping And Public Transport Links**
- **Close To Promenade And Local Amenities**

Every care has been taken with the preparation of these Particulars but complete accuracy cannot be guaranteed. If there is any point, which is of particular importance to you, we will be pleased to check the information for you. These Particulars do not constitute a contract or part of a contract.

All measurements quoted are approximate and plans are for general guidance and are not to scale. The Fixtures, Fittings & Appliances have not been tested and therefore no guarantee can be given that they are in working order. Photographs are reproduced for general information and it cannot be inferred that any item shown is included in the sale.

Company Details - Farrell Heyworth Limited.

Registered Office: Second Floor Office Suite, The Pavillion, Church Street, Lancaster, LA1 1EX

Registered in England No. 3798432

Directors CP Heyworth FNAEA, JF Collins, JR Collins, SW Penny FRICS, JAG Shellcross MNAEA, JA French

EPC D

www.farrellheyworth.co.uk



We are pleased to offer for sale this terraced house located in a popular residential location of Morecambe.

The property is currently split into three one bedroom flats with tenants in situ.

Each flat comprises lounge, kitchen, shower room and bedroom.

The ground floor also has a dining room and access to a rear yard.

This is a great investment opportunity, the property should be viewed to be fully appreciated.

Tenure: Freehold
Freehold information: Each flat is in council tax band A
Council Tax: Band A



