

£129,950

Staining Avenue, Ashton
On Ribble, Preston PR2

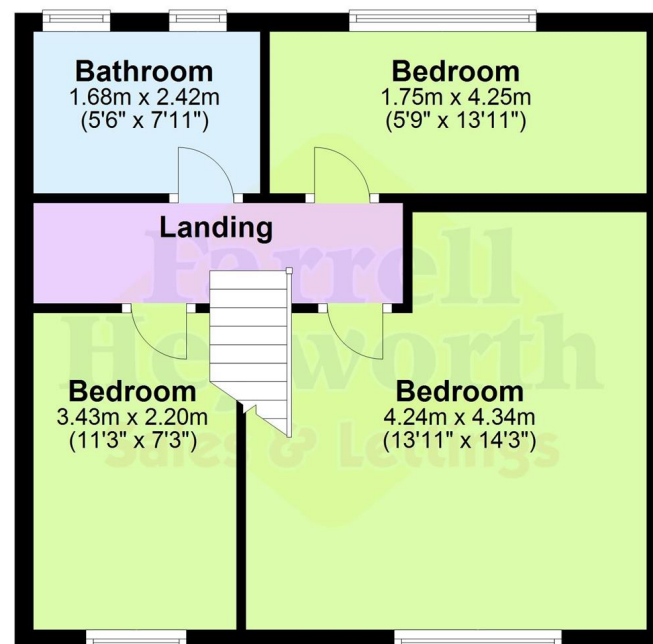

Ground Floor



First Floor

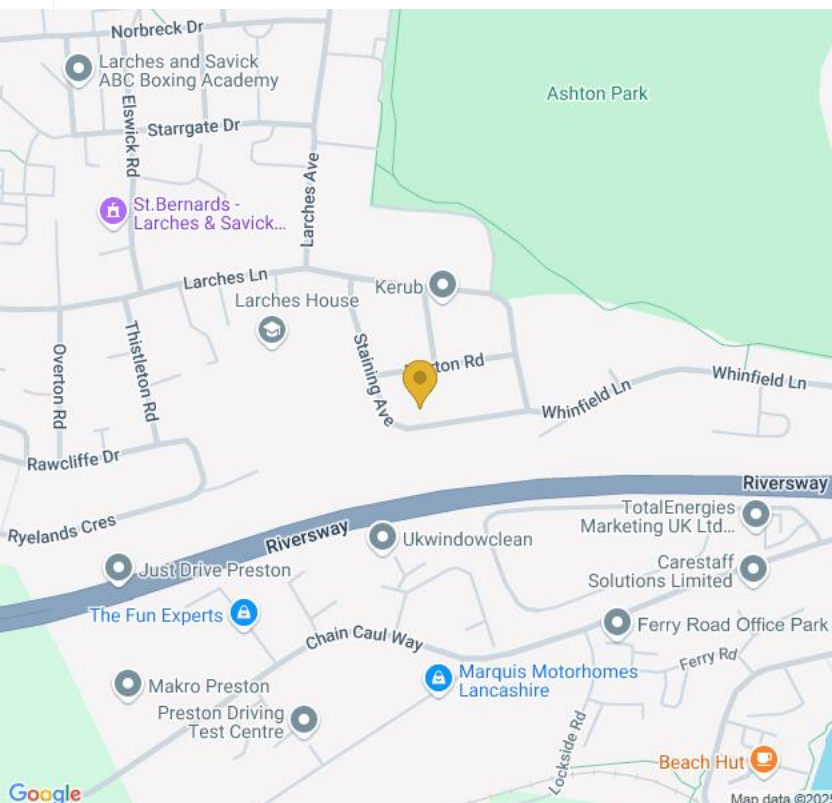

Preston
309 Garstang Road
Preston PR2 9XJ

Tel: 01772 203345

Email: preston@farrellheyworth.co.uk
<https://www.farrellheyworth.co.uk/preston>

Company Details - Farrell Heyworth Limited.

Registered Office: Second Floor Office Suite, The Pavillion, Church Street, Lancaster, LA1 1EX

Registered in England No. 3798432

Directors CP Heyworth FNAEA, JF Collins, JR Collins, SW Penny FRICS, JAG Shellcross MNAEA, JA French



- **Three Bedroom Family Home in Great Location**
- **Spacious Lounge and Dining Kitchen**
- **Gardens to Front and Rear**
- **Situated close to local amenities, shops and transport links**
- **Call now for more information**

Every care has been taken with the preparation of these Particulars but complete accuracy cannot be guaranteed. If there is any point, which is of particular importance to you, we will be pleased to check the information for you. These Particulars do not constitute a contract or part of a contract.

All measurements quoted are approximate and plans are for general guidance and are not to scale. The Fixtures, Fittings & Appliances have not been tested and therefore no guarantee can be given that they are in working order. Photographs are reproduced for general information and it cannot be inferred that any item shown is included in the sale.

EPC C

www.farrellheyworth.co.uk



This good size property comprises a hallway, spacious lounge and dining kitchen, three bedrooms and fitted bathroom suite.

Please call us today to avoid missing out on this superb property.

Tenure: Freehold
Council Tax: Band B





**We can search
1,000s of
mortgages
for you**

1 adviser - 80 lenders - 10,000 mortgage schemes!



**Mortgage
Advice Bureau**

Call: 0800 389 1666
Online: www.mortgageadvicebureau.com/farrelltheyworth

**Your home may be repossessed if you do not keep up repayments on your mortgage.
 There will be a fee for mortgage advice. The actual amount you pay will depend upon your
 circumstances.**

MAB 6451